

GENERAL CONSTRUCTION NOTES:

1. DO NOT SCALE DRAWING TO OBTAIN DIMENSIONS.
2. ALL WORK MUST BE EXECUTED IN AN ORDERLY AND CAREFUL MANNER WITH DUE CONSIDERATION FOR OWNER, EMPLOYEES, AND THE PUBLIC SAFETY.
3. CONTRACTOR MUST PROVIDE DUST AND ACCESS BARRICADES AS REQUIRED SO AS TO PROTECT PROPERTY, ADJACENT STRUCTURES, UTILITIES, STREETS, PEDESTRIANS, AND THE GENERAL PUBLIC.
4. CONTRACTOR MUST CONFIRM ALL FIELD CONDITIONS AND DIMENSIONS. CONTRACTOR IS SOLELY RESPONSIBLE FOR THEM.
5. IF WORK EXPOSES ANY CRACKS, SEPARATIONS, OR OPENINGS, THEN THE CONTRACTOR WILL NOTIFY THE ENGINEER, WILL CLEAN AND FILL WITH NON-CRINK GROUT, AND WILL FOLLOW ENGINEER'S OTHER INSTRUCTIONS.
6. CONTRACTOR MUST FURNISH ALL NECESSARY AND REQUIRED TEMPORARY OR PERMANENT SHORING, BRACING, SUPPORTS, ETC.
7. CONTRACTOR MUST NOTIFY ENGINEER OF ANY AND ALL DIFFERING SITE CONDITIONS.
8. THE ENGINEER IS NOT IN CHARGE OR RESPONSIBLE FOR THE CONSTRUCTION METHODS, TECHNIQUES, SEQUENCES, PROCEDURES, OR SAFETY PRECAUTIONS IN CONNECTION WITH THE CONSTRUCTION WORK OR THE ACTS OR OMISSIONS OF THE CONTRACTOR, SUBCONTRACTOR, OWNER OR ANY OTHER PERSON PERFORMING ANY WORK, OR FAILURE OF ANYONE TO CARRY OUT THE WORK IN ACCORDANCE WITH THE CODES.
9. THE ENGINEER IS NOT RESPONSIBLE FOR SITE CONDITIONS, PRIOR TO BIDDING OR CONSTRUCTION. CONTRACTOR IS RESPONSIBLE TO VERIFY ALL SITE CONDITIONS AND DIMENSIONS ON THE DRAWINGS AND NOT ON THE DRAWINGS AND NOTIFY THE ENGINEER IN WRITING OF ANY DISCREPANCIES.
10. ALL WORK MUST CONFORM TO THE IBC 2021, IRC 2021, AND THE LATEST EDITION OF THE NEW CASTLE COUNTY BUILDING CODE.
11. SIZE AND/OR LOCATION OF EXISTING STRUCTURES AND UTILITIES SHOWN ON THE STRUCTURAL DOCUMENTS ARE FOR THE CONTRACTOR'S CONVENIENCE ONLY. THE CONTRACTOR IS SOLELY RESPONSIBLE TO VERIFY BY FIELD MEASUREMENTS AND INVESTIGATION THE SIZE AND/OR LOCATION OF ALL EXISTING STRUCTURES AND UTILITIES.

EXISTING CONDITIONS NOTES:

1. ALL EXISTING CONSTRUCTION SHOWN ON THESE DRAWINGS IS PROVIDED FOR REFERENCE ONLY. EXISTING CONSTRUCTION, DIMENSIONS, LOCATIONS, ELEVATIONS, ETC. MUST BE VERIFIED IN THE FIELD (VIF) PRIOR TO REMOVAL OR MODIFICATION OF ANY EXISTING STRUCTURAL MEMBER AND SHOP DRAWING PREPARATION, FABRICATION, AND CONSTRUCTION OF NEW WORK.
2. SHOULD EXISTING CONDITIONS DIFFER FROM THAT SHOWN ON THE CONTRACT DOCUMENTS, CONTRACTOR MUST NOTIFY THE ENGINEER PRIOR TO CONTINUATION OF WORK.
3. EXISTING STRUCTURAL MEMBERS MUST NOT BE CUT OR MODIFIED UNLESS SPECIFICALLY SHOWN HEREIN OR UNLESS PRIOR WRITTEN APPROVAL BY THE ENGINEER IS OBTAINED.
4. CONTRACTOR MUST TAKE NECESSARY PRECAUTIONS TO PROTECT THE EXISTING STRUCTURE AND ADJACENT STRUCTURES FROM DAMAGE DURING SHORING, LIFTING, EXCAVATING, DEMOLITION, AND CONSTRUCTION OF NEW WORK.
5. EXISTING STRUCTURAL DOCUMENTS ARE NOT AVAILABLE. VERIFY IN FIELD (VIF) EXISTING CONDITIONS, STRUCTURAL MEMBER SIZES, AND LOCATIONS, PRIOR TO NEW WORK.

MEANS AND METHODS NOTES:

1. THE CONTRACTOR IS RESPONSIBLE FOR PROVIDING MEANS AND METHODS FOR THE CONSTRUCTION OF THE PROJECT.
2. THE CONTRACTOR MUST ENGAGE A PROFESSIONAL ENGINEER FOR MEANS AND METHODS OF CONSTRUCTION, INCLUDING BUT NOT LIMITED TO SCAFFOLDING, SHORING, UNDERPINNING, TEMPORARY BRACING, HOISTING, AND STORING OF EQUIPMENT OR MATERIAL ON THE EXISTING STRUCTURE.
3. THE CONTRACTOR'S ENGINEER MUST REFER TO SITE STANDARDS AND GUIDELINES FOR ADDITIONAL REQUIREMENTS.
4. THE CONTRACTOR MUST INSPECT, ACCESS, AND VERIFY THE EXISTING CONDITIONS AND EXTENT OF WORK PRIOR TO COMMENCING DEMOLITION OR CONSTRUCTION OF NEW WORK.
5. THE CONTRACTOR MUST PROVIDE NECESSARY EQUIPMENT AND PERTINENT MATERIAL, INCLUDING BUT NOT LIMITED TO LADDERS, LIFTS, AND OTHER CONSTRUCTION EQUIPMENT FOR THE COMPLETION OF THE WORK INDICATED ON THE CONTRACT DOCUMENTS.
6. THE CONTRACTOR MUST PROVIDE SAFETY AND FALL PROTECTION IN ACCORDANCE WITH OSHA REGULATIONS AND SITE SAFETY GUIDELINES.

TIMBER/WOOD NOTES:

1. ALL STRUCTURAL FRAMING LUMBER MUST BE HEM FIR #2, DOUGLAS-FIR LARCH #2 OR BETTER, OR SOUTHERN PINE #2 OR BETTER.
2. LUMBER DESIGN IS BASED UPON THE FOLLOWING:

EXTREME FIBER BENDING	= 1,000 PSI (SINGLE MEMBER USE)
	= 1,150 PSI (REPETITIVE MEMBER USE)
MODULUS OF ELASTICITY	= 1,400,000 PSI
HORIZONTAL SHEAR	= 75 PSI
COMP. PERP TO GRAIN	= 405 PSI
3. PARALLEL STRANDED LUMBER (PSL) DESIGN IS BASED UPON THE FOLLOWING:

EXTREME FIBER BENDING	= 2,800 PSI
MODULUS OF ELASTICITY	= 2,000,000 PSI
HORIZONTAL SHEAR	= 285 PSI
COMP. PERP TO GRAIN	= 500 PSI
4. PROVIDE A (3) 2X POST (MINIMUM) AT EACH BEAM/HEADER BEARING LOCATION, UNLESS OTHERWISE NOTED. POSTS MUST RUN CONTINUOUS TO EITHER BEAM SUPPORTS OR THE FOUNDATION.
5. NAILING OF ALL FRAMING MUST BE IN ACCORDANCE WITH "FASTENING SCHEDULE" OF THE LATEST INTERNATIONAL BUILDING CODE.
6. ALL TIMBER AND TIMBER CONSTRUCTION MUST COMPLY WITH SPECIFICATIONS AND CODES SPECIFIED BELOW:
 - AMERICAN INSTITUTE OF TIMBER CONSTRUCTION: TIMBER CONSTRUCTION MANUAL.
 - NATIONAL FOREST AND PAPER ASSOCIATION/NATIONAL WOOD COUNCIL: NATIONAL DESIGN SPECIFICATIONS FOR WOOD CONSTRUCTION.
 - AMERICAN PLYWOOD ASSOCIATION: PLYWOOD DESIGN SPECIFICATIONS.
 - AMERICAN WOOD-PRESERVERS ASSOCIATION STANDARDS.
 - NATIONAL LUMBER MANUFACTURERS ASSOCIATION: NATIONAL DESIGN SPECIFICATIONS FOR STRESS-GRADE LUMBER AND ITS FASTENINGS.
7. ALL WORK MUST CONFORM TO THE IRC 2021.

PENN VALLEY ENGINEERING LLC
Structural Engineers & Consultants
 P.O. BOX 2651
 CINNAMINSON, NJ 08077

 PHONE: (215) 821-7686
 FAX: (856) 829-8631

WWW.PENNVALLEYENGINEERING.COM



KNOW WHAT'S BELOW.
CALL BEFORE YOU DIG.

<p>PROPOSED</p> <p>FOUNDATION REPAIRS</p>	REVISIONS:

(VIF) = VERIFY IN FIELD BY CONTRACTOR, PROJECT MANAGER, AND OWNER PRIOR TO START OF ANY WORK



P.O. BOX 2651
CINNAMINSON, NJ 08077

PHONE: (215) 821-7686
FAX: (856) 829-8631

WWW.PENNVALLEYENGINEERING.COM

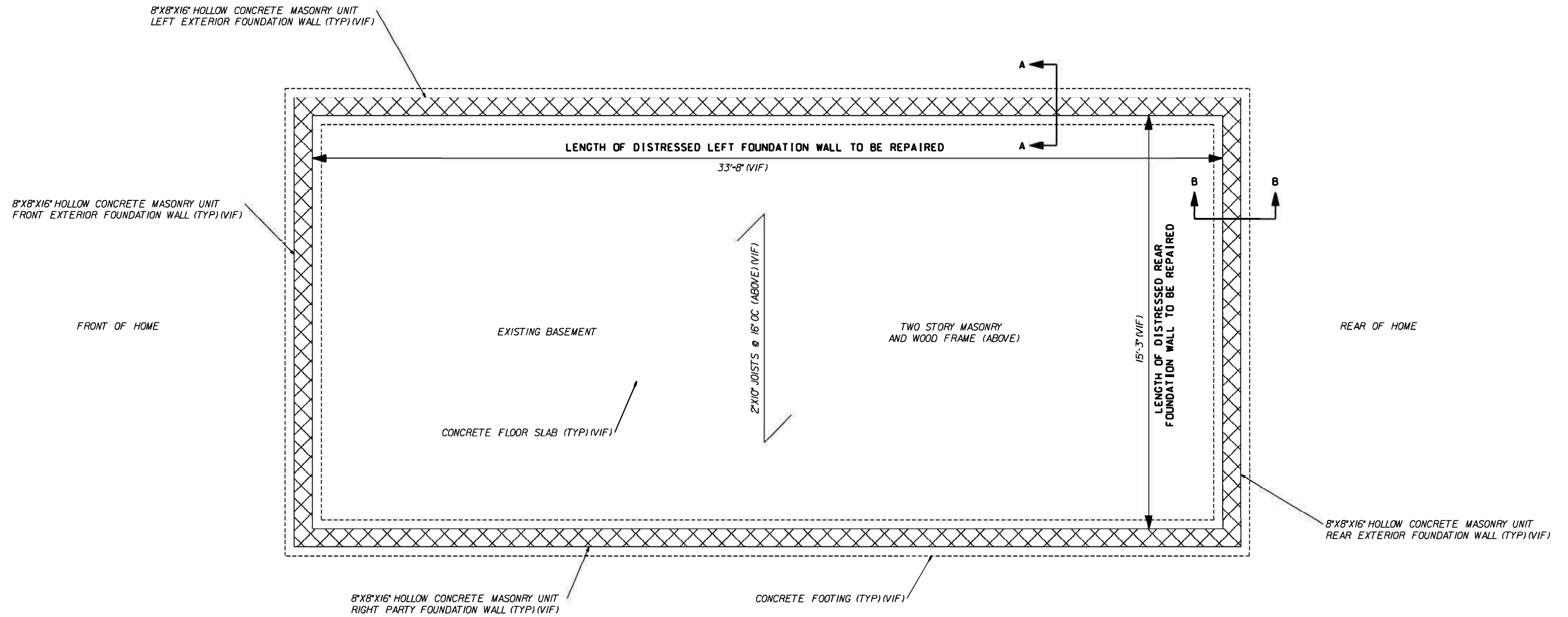

BASEMENT LEVEL FLOOR PLAN

SCALE: 1/2" = 1'

PROPOSED FOUNDATION REPAIRS	REVISIONS:

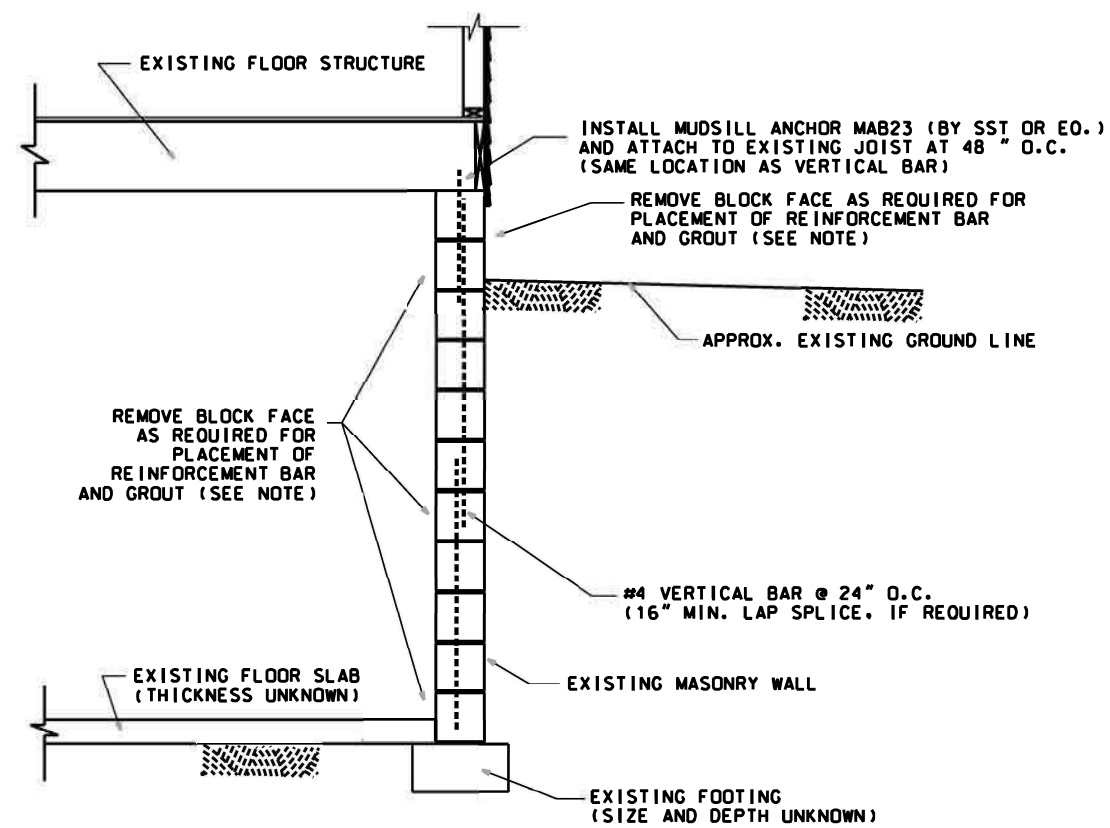

TYPICAL WALL SECTION A-A

SCALE: NTS

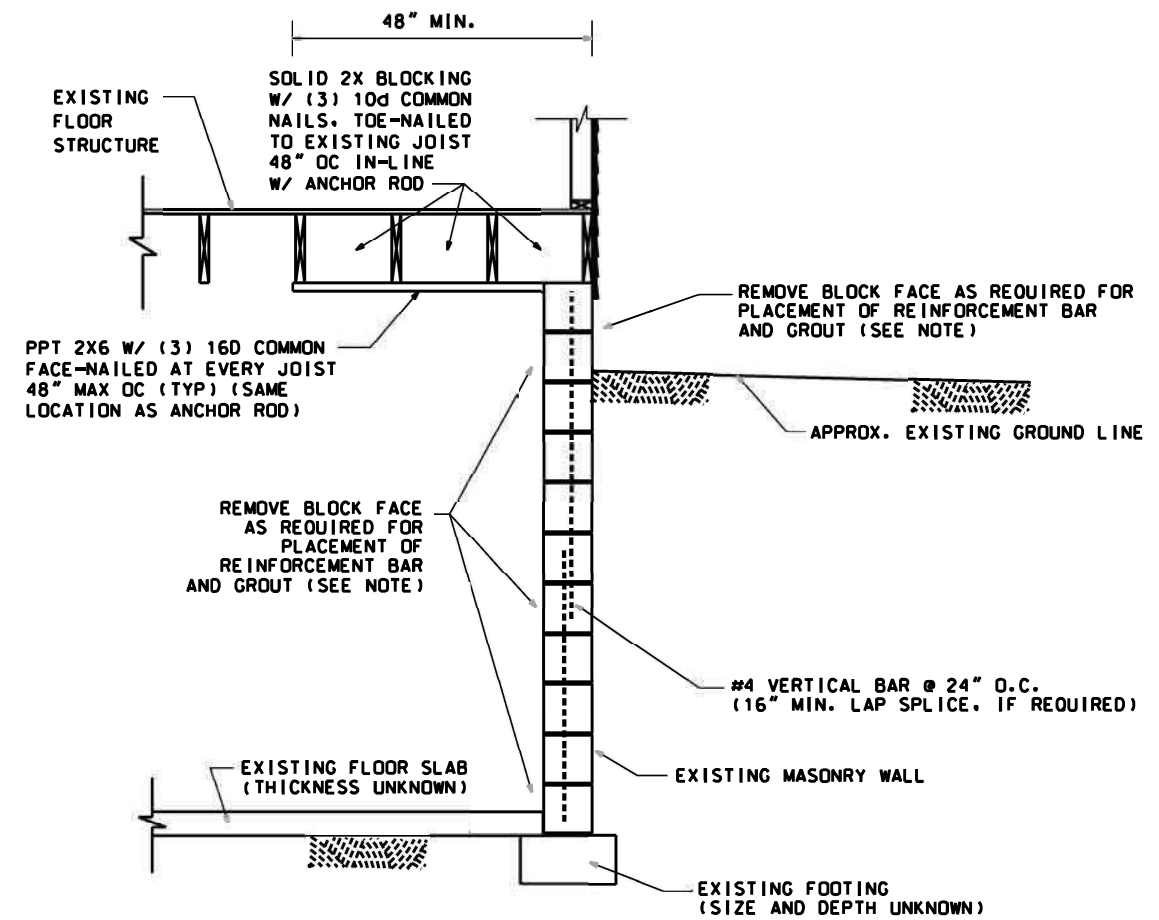

TYPICAL WALL SECTION B-B

SCALE: NTS

TYPICAL WALL SECTION NOTES:

1. REINFORCEMENT BARS MAY BE INSTALLED FROM THE INTERIOR OF EXTERIOR AS FIELD CONDITIONS ALLOW. (VIF)
2. GROUT MUST BE INSTALLED WITH A MECHANICAL VIBRATOR TO ALLOW FOR COMPLETE CONSOLIDATION.

PROPOSED
FOUNDATION REPAIRS

REVISIONS:

NO.	DATE	DESCRIPTION